



# JUSTICE

# GUIDE

The modern-day correctional facility has shifted to reflect the growing recognition that rehabilitation is a vital part of the correctional system, and that providing inmates with the tools and resources they need to succeed can help reduce recidivism and promote public safety.

At Norix, our mission of **balancing safety & security with humanizing challenging environments** is at the heart of every product we create. Our team of designers and engineers scrutinize over every minute detail with a fundamental focus on producing innovative products with **Features That Matter**, for both the inmates on their rehabilitative journey and the staff members dedicating their lives to this effort.

## The Features That Matter

---

ANTI-LIGATURE DESIGN

---

BALLASTABLE

---

CONTRABAND RESISTANT

---

EASY CLEANABILITY

---

ERGONOMIC DESIGN

---

EXTREME DURABILITY

---

GREENGUARD GOLD CERTIFIED

---

NON-REMOVABLE GLIDES

---

RECYCLABLE

---

ROUNDED EDGES

---

TAMPER RESISTANT

---

TRUCOLOR™ TECHNOLOGY

---

**BALANCING  
SAFETY &  
SECURITY WITH  
HUMANIZING  
CHALLENGING  
ENVIRONMENTS.**

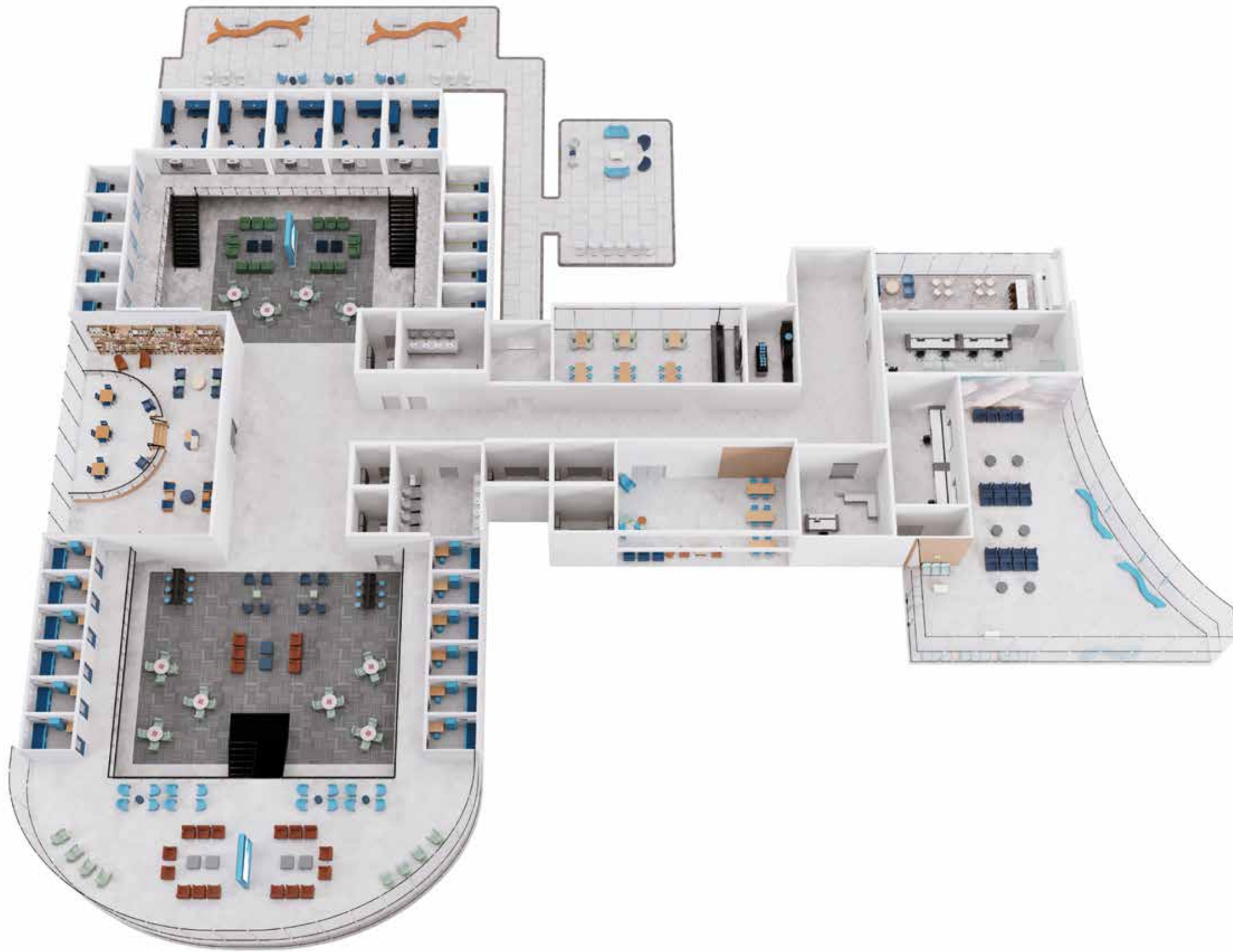

# FULL FACILITY FURNITURE SOLUTION

LOBBY/INTAKE

VISITATION

DAYROOM

CAFETERIA

GROUP ROOM

OUTDOOR SPACE

LIBRARY/FLEX SPACE

STAFF AREAS

WITH OVER 40 YEARS OF  
EXPERIENCE WORKING WITH  
CHALLENGING ENVIRONMENTS,  
NORIX PROVIDES PROVEN  
FURNITURE SOLUTIONS FOR  
YOUR ENTIRE FACILITY.



# LOBBY/INTAKE

A well-designed lobby and intake area is essential to the smooth operation of a correctional facility. The seating and tables used in this space must be able to maintain high durability levels and easy cleanability while simultaneously contributing to the overall aesthetic of the space.

## PRODUCTS

- |    |        |    |               |
|----|--------|----|---------------|
| 1. | Terra  | 4. | Hondo Nuevo   |
| 2. | Mix-Up | 5. | Riptide Bench |
| 3. | Tabla  |    |               |

As the first point of contact for inmates, as well as visitors, lobby and intake areas play a critical role in setting a precedent for the overall safety and security of the entire facility. The strategic use of design elements, such as the use of natural light and an open floor plan, can be used to help ease tension for both inmates and staff members.

#### SAFETY AND SECURITY

Utilizing open sightlines and designating clear paths allows for security members to efficiently address any potential safety or security concerns. The furniture situated in these areas must be highly durable and offer easy cleanability to combat heavy traffic and the heightened probability of encountering willful abuse.





# VISITATION

Visitation areas can play a key role in improving the mental health of inmates by providing a sense of normalcy and social connection with their loved ones. In turn, this can result in reduced tension and conflict within the facility.

## PRODUCTS

- |                      |                |
|----------------------|----------------|
| 1. Leg-Style Table   | 5. Hondo Nuevo |
| 2. Progress          | 6. A-Maze      |
| 3. Forté® Guest      | 7. Hex-It      |
| 4. Forté® Occasional | 8. RockSmart®  |

A well-designed visitation area can improve the overall perception of the facility, both among visitors and within the broader community. The effective use of design elements such as natural lighting, the considerate use of color and the layout of the room can help improve morale and reduce the potential for conflict.

#### NATURAL LIGHTING

Access to natural light has been shown to improve mood and enhance well-being, which can be particularly important in an environment as stressful as a visitation area. By allowing natural light to enter, facilities also earn the additional benefit of relying less on artificial lighting, which can save on energy costs and reduce their environmental impact.

#### USE OF COLOR

The appropriate use of color can have a substantial impact on the emotional well-being of both inmates and their visitors. Natural color hues can help create a calming atmosphere that reduces stress and anxiety, thus creating a safer and more secure environment with reduced risk of violent outbursts.





# DAYROOM

Dayrooms are subjected to the difficult task of finding the proper balance between creating a warm, homelike atmosphere and maintaining high levels of safety, security and cleanliness. A combination of thoughtful design and furniture specifically engineered to excel in these challenging environments is essential for achieving and sustaining this balance.

## PRODUCTS

- |                  |                |
|------------------|----------------|
| 1. Intelestation | 5. Hondo Nuevo |
| 2. Vesta Guest   | 6. RockSmart®  |
| 3. X-Base        | 7. B-Side®     |
| 4. Coupe™        |                |



As the area in which inmates spend the majority of their waking hours, it's vital for dayrooms to closely reflect a normalized environment that mirrors life outside the facility. An open-plan concept that provides multiple settings for use throughout the day can help support inmates on their journey towards rehabilitation.

#### FLEXIBLE FURNISHING

Non-removable, stainless steel floor glides allow tables and chairs to slide along the floor, making it easy for staff members to reconfigure the layout of the room to accommodate a variety of situations. While designed to easily slide, these pieces are robustly engineered in order to mitigate their ability to be thrown or weaponized.

#### OUTDOOR CONNECTIONS

The use of realistic art pieces, such as murals, that reflect nature can be used help blur the lines between interior and exterior, resulting in reduced anxiety and agitation among inmates. Employing nature as a healing distraction has proven to be beneficial for all ages.





1

2

# CAFETERIA

The furniture used in the cafeteria of your facility not only provides a functional purpose of seating and dining but also sets the tone for the environment and influences the behavior of the inmates. Table and seating options need to be durable, tamper-resistant, and easy to clean to withstand the wear and tear of daily use.

## PRODUCTS

1. Oasis®
2. Max-Master®

The cafeteria should be designed to promote a sense of community and encourage positive interactions among inmates. As a high traffic area, open sight lines are key for maintaining a safe and secure environment.

#### OPEN FLOOR PLAN

Implementing an open floor plan can offer a variety of benefits for both inmates and staff members. For inmates, it can result in reduced anxiety by allowing the room to feel less crowded. It also offers improved visibility in the space, making it easier for staff to maintain visual contact with inmates and quickly address potential safety or security threats.

#### TAMPER RESISTANCE

Fully welded joints, non-removeable glides and the use of security hardware are just a few examples of how Norix products go above and beyond to preserve the safety and security of both inmates and staff. Loose parts in a correctional environment not only compromises the safety of the furniture but can result in the creation weapons or other forms of contraband.





# GROUP ROOM

The implementation of design elements, like natural lighting and pops of color, have shown to have a positive impact on inmate mental health. For group room cells, it's important to incorporate a component of privacy without jeopardizing safety. Cells with open-plan concepts can achieve this sense of privacy with property storage containers.

## PRODUCTS

- |                      |                     |
|----------------------|---------------------|
| 1. Jupiter Table     | 5. Citadel® Storage |
| 2. Integra           | 6. Wall Bunk        |
| 3. Ironman® Bunk     |                     |
| 4. Marathon Mattress |                     |

Correctional facilities that adopt healthcare evidence-based design concepts, like access to natural light, color application and various connections to nature, are experiencing the benefits these elements can have on the mental and social behavior of inmates.

#### MATERIAL USE

Highly durable and easily sanitized materials, like Norix's rotomolded options, are vital for maintaining a safe environment for both inmates and staff. In addition to providing a similar level of durability and cleanability as the classic steel options, rotomolded plastic furnishings offer a softer feel and a variety of color options to help make the facility feel more comfortable and less institutional.



#### PRODUCTS

1. Attenda® Stool
2. Attenda® Wall Desk
3. Attenda® 4 Shelf
4. Attenda® Cubby Bed
5. Marathon Mattress
6. Citadel® Storage
7. SafeStore



# OUTDOOR SPACE

The outdoors has proven to be an ideal nurturing environment, full of fresh air and natural light. Allowing access to the outdoors allows inmates the opportunity to actively engage in their own recovery.

## PRODUCTS

- |               |            |
|---------------|------------|
| 1. Goby®      | 4. Coupe™  |
| 2. Riptide    | 5. B-Side® |
| 3. RockSmart® |            |

With human biology deeply rooted in nature, outside environments can offer inmates a sense of familiarity and comfort that supports general well-being.

#### OUTSIDE OPPORTUNITIES

Outdoor areas, such as a courtyard, an outdoor garden or recreational area, can act as a sanctuary for inmates young and old. Outdoor exercise has been shown to reduce stress and anxiety levels, improve sleep quality and help prevent cognitive decline.





# LIBRARY/FLEX SPACE

A library or multi-purpose space is a key resource for supporting inmates seeking to further their education, receive vocational training or exercise spiritual growth. These activities can offer inmates a sense of purpose, hope, and inner peace, which can have a positive impact on their mental health and overall well-being.

## PRODUCTS

- |                       |             |
|-----------------------|-------------|
| 1. Mix-Up Large Round | 6. Progress |
| 2. Mix-Up Series      | 7. B-Side®  |
| 3. Toro               | 8. Wink     |
| 4. RockSmart®         | 9. Tabla    |
| 5. Leg-Style Table    |             |



A variety of table and seating combinations can be used to create independent areas for solitary learning or for group sessions. The furniture used in these spaces needs to be highly durable and easy to clean to endure daily use, but should also offer a degree of ergonomic comfort to encourage knowledge growth among inmates.

#### ACCOMMODATIONS FOR VOCATION & SPIRITUAL GROWTH

Supporting vocation and spiritual growth among inmates can help reduce the likelihood of recidivism and play a critical role in their successful reintegration into society. Investing in their personal and professional development can help break the cycle of incarceration and create a more just and equitable society.





# STAFF AREAS

Facilities that emphasize the considerate use of design can create pleasant environments that greatly improve the living and working conditions for staff, who spend considerably more time in the facility than the offenders themselves. Supplying staff with areas of relief and spaces to collaborate with other staff members can have a positive impact on their mental, emotional and physical well-being.

## PRODUCTS

- |    |               |    |               |
|----|---------------|----|---------------|
| 1. | Tabla         | 4. | Multi-Purpose |
| 2. | Element Chair | 5. | Forma         |
| 3. | Affinity      | 6. | Element Sofa  |

Comfortable seating options that feature a variety of warm, inviting color options are ideal for creating a peaceful environment for staff to relax and recharge. Developing staff areas with a focus on the welfare of staff members can not only improve the day-to-day life of the staff, but also have a positive impact on overall inmate care.

#### A VARIETY OF FABRICS

Access to hundreds of unique fabric options makes it easy to find an ideal option to fit any facility. Fabrics with texture and patterns are less susceptible to visible wear because they more easily hide imperfections, while vinyl fabric options are the best choice when cleanability is top of mind.

#### ERGONOMIC COMFORT

Ergonomic comfort is vital to providing a relaxing environment for staff members to recharge. Creating a space for staff to refresh physically and mentally can result in better, more attentive inmate care.





AT NORIX, WE DESIGN  
INNOVATIVE, ROBUST FURNITURE  
THAT MEETS THE REAL-WORLD  
NEED FOR HUMANIZING  
CHALLENGING ENVIRONMENTS

The success of Norix is due to the dedication to our customers, the community, and employees. As we strive to care for our environment and our people, we seek to change in small ways, such as how we live our personal lives, and significant ways such as how we make decisions at Norix Furniture.

**Interested in our products?**

Call us to schedule a tour of our showroom  
**630-231-1331**



AT NORIX, WE DESIGN INNOVATIVE,  
ROBUST FURNITURE THAT MEETS THE  
REAL-WORLD NEED FOR HUMANIZING  
CHALLENGING ENVIRONMENTS.

# ENGINEERED TO ENDURE<sup>®</sup>

**NORIX**<sup>®</sup>  
J U S T I C E

One Innovation Drive, West Chicago, Illinois 60185  
Phone: 630-231-1331 / Toll Free: 800-234-4900 / Fax: 630-231-4343  
furniture@norix.com | ©2023 Norix Group, Inc. | Printed 6/23

**NORIX.COM**